

ELEVATION

PLOT AREA : 1412 SQ.FT
PRO. AREA : 410 SQ.FT

Planning Permit No. A/452/91
APPROVED
SUBJECT TO THE CONDITIONS IN THIS OFFICE ORDER
No. A/19398/90
FOR MEMBER SECRETARY
MADRAS METROPOLITAN DEVELOPMENT AUTHORITY
MADRAS 600 008

SECTION ON AB

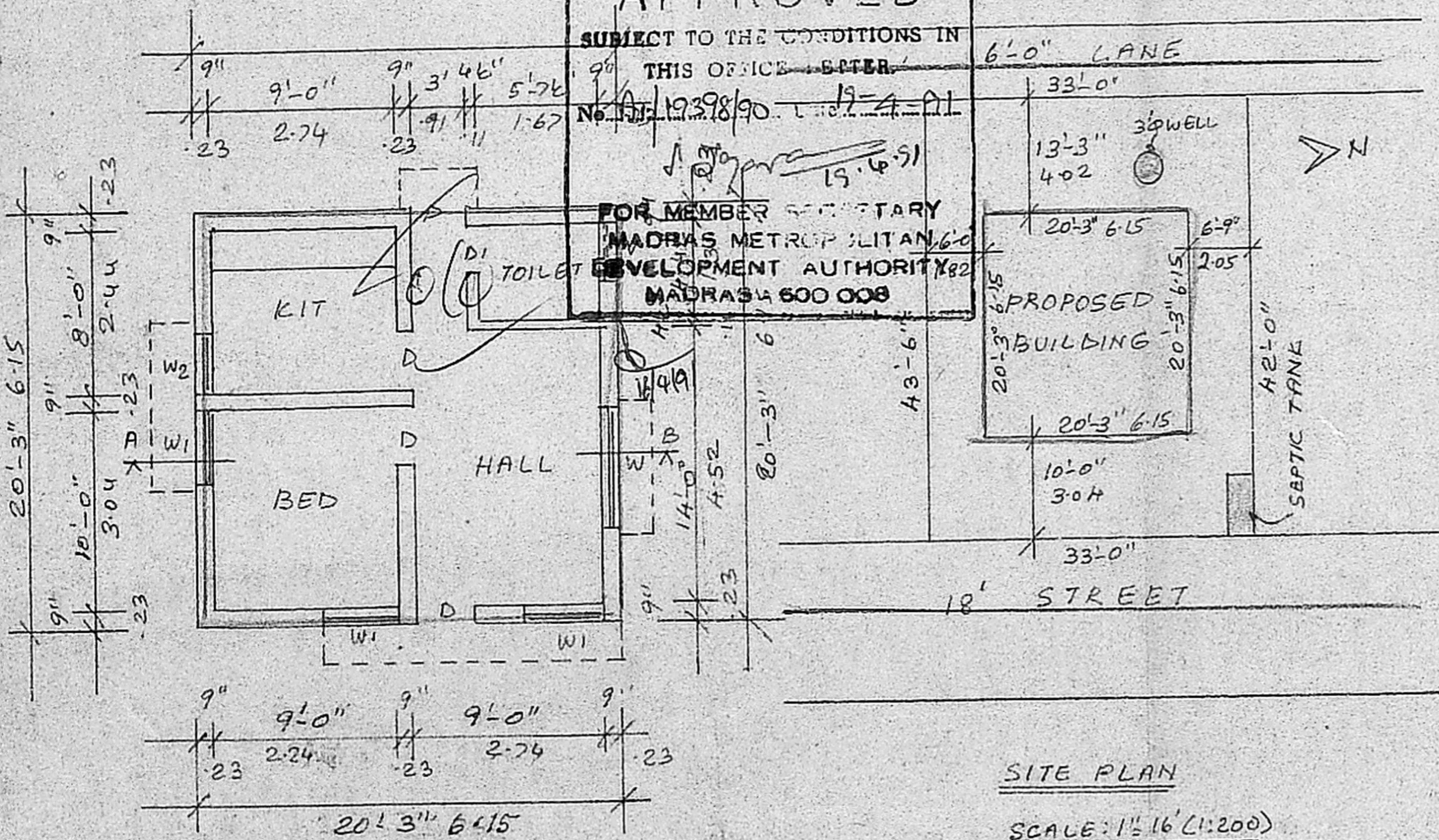

PLAN

SITE PLAN
SCALE: 1" = 16' (1:200)

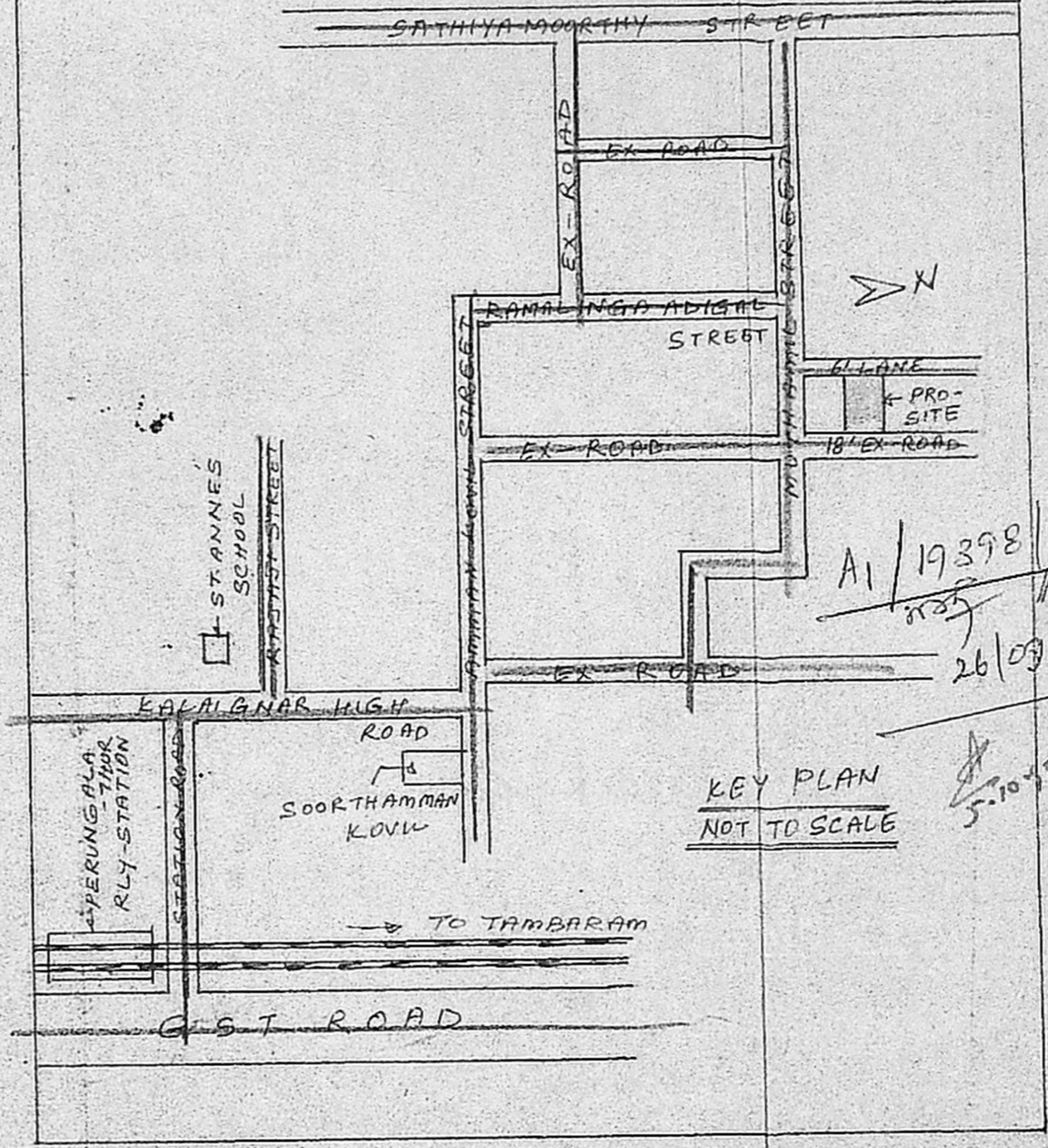

KEY PLAN
NOT TO SCALE

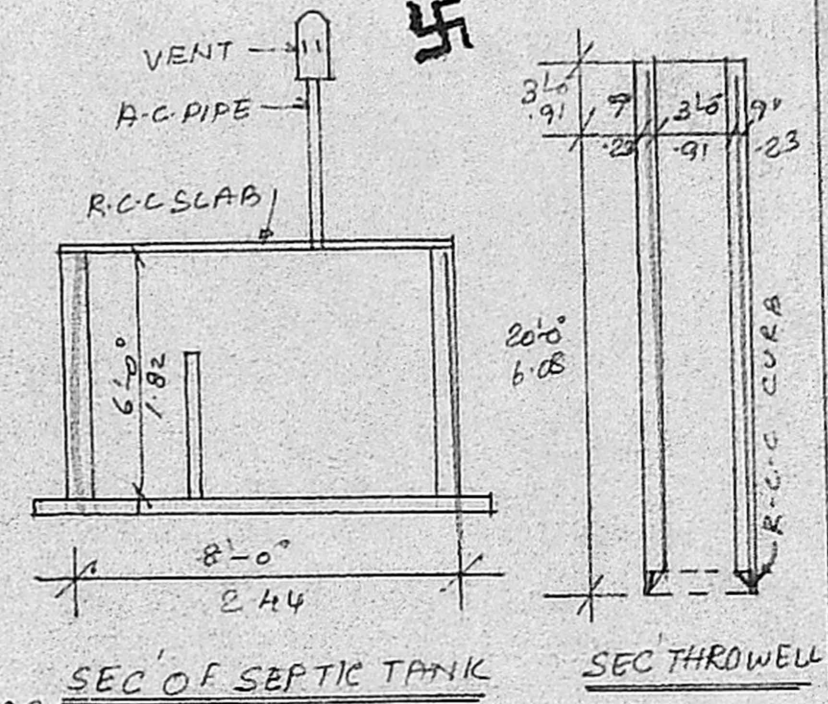

SEC OF SEPTIC TANK
SEC THROWWELL

SCHEDULE OF JOINERY

D1	PANELLED DOOR	3'-0" x 7'-0"	91 x 210
D2	-DO-	2'-6" x 6'-0"	75 x 182
W	PANELLED WINDOW	6'-0" x 4'-6"	182 x 137
W1	-DO-	4'-0" x 4'-6"	122 x 137
W2	-DO-	3'-0" x 3'-6"	91 x 91
V	VENTILATOR	3'-0" x 2'-0"	91 x 61

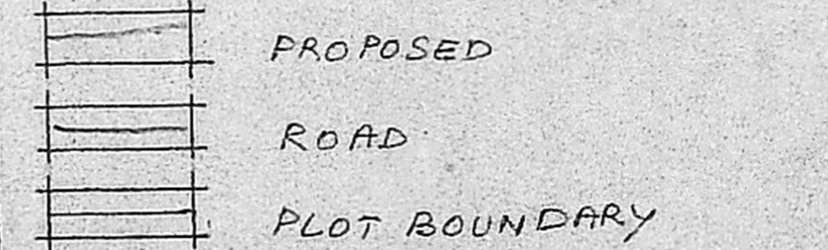

PLAN SHOWING THE PROPOSED RESIDENTIAL BUILDING IN R.S. NO. 72/ALPE, AT PEERKANKARANAI VILLAGE, SAIDAPET TALUK, CHINGLEPUT DISTRICT. SCALE: 1" = 8'-0" (1:100)

REFERENCE
P.C.C 1:4:8 FOR FOUNDATION & FLOORING.
SAND FILLING FOR FOUNDATION & FLOORING
BRICK WORK INC. M1.5 FOR WALLS. ALL R.C.C WORK INC. C 1:2:4. PLASTERING WITH C.M. 1:3, 3/4" TK. WEATHERING COURSE FIXING THE PRESSED TILES WITH C.M. 1:3, 3/4" TK

OWNER
S. Ekambaram

Phone: 440782
R. Mohan Rao, D.C.B.
LICENSED SURVEYOR
Corporation of Madras
REG. No: 14
AMBATTUR TOWN SHIP
ALANDUR MUNICIPALITY
Consulting Engineer & Contractor
Office: 15, Madley Road
T. NAGAR, MADRAS-600 085